

# PHASE I

- REMOVE FARMHOUSE
- MAINTAIN WELL & EX POWER
- MAINTAIN SCHOOL BUILDING & OUTBUILDINGS
- CONSTRUCT PAVILION & ACCESS PATH
- ROUGH IN GRAVEL LOOP DRIVE & SOME PARKING

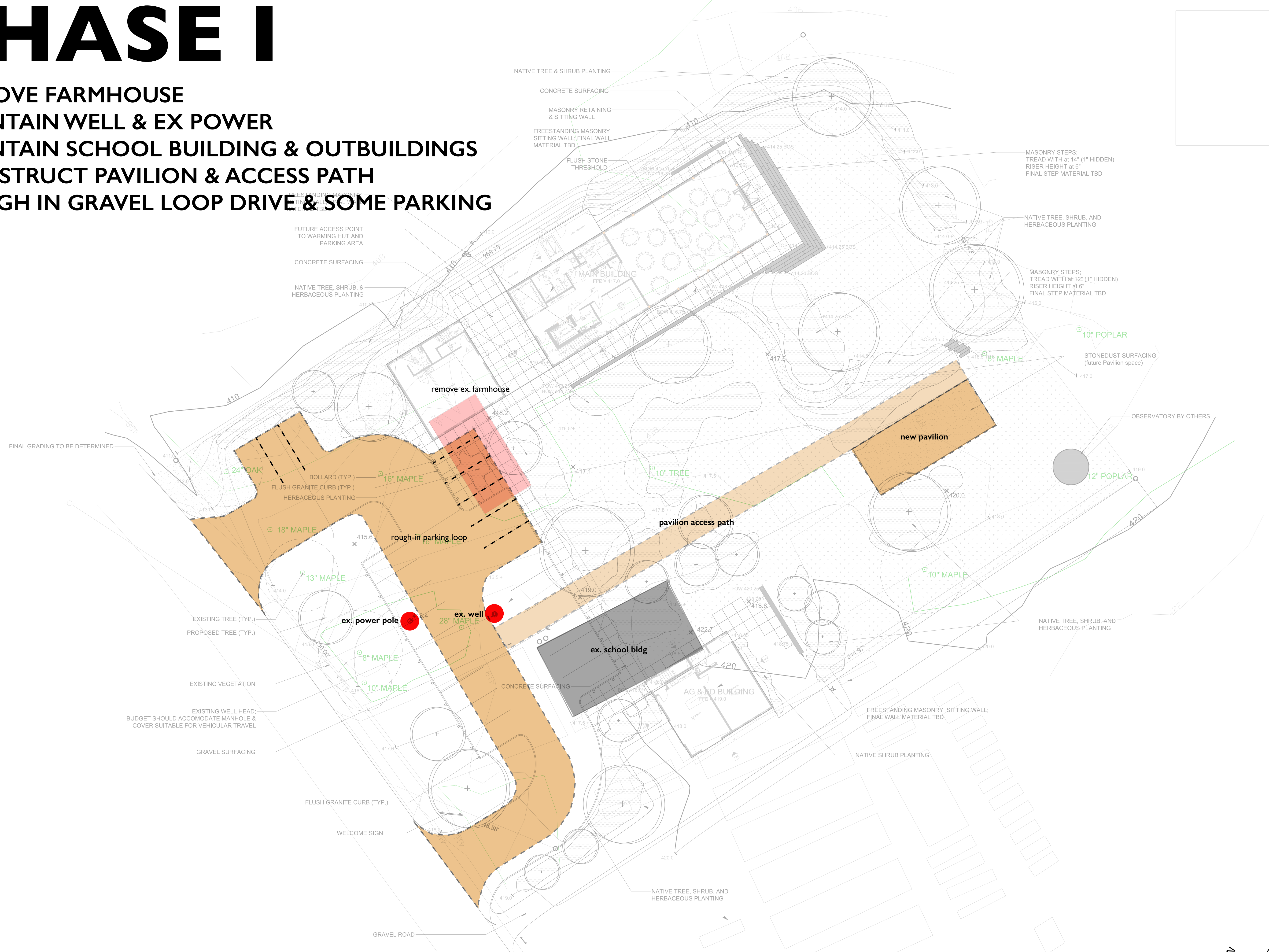

**ESTIMATED LANDSCAPE TOTAL COST PERCENTAGE = 0%**  
 (does not include site engineering costs)

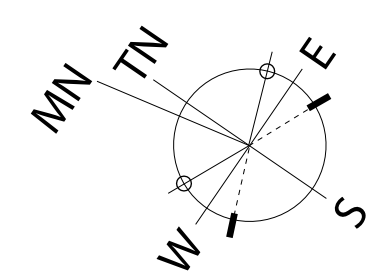

# PHASE II

- REMOVE SCHOOL BUILDING
- RE-LOCATE POWER & ENCLOSE WELL (Manhole Access)
- CONSTRUCT OFFICES & CLASSROOM BLDG & ASSOCIATED ACCESS PATH
- INSTALL SEPTIC FIELD / INFRASTRUCTURE
- ROUGH IN ENTIRE PARKING AND DROP-OFF AREA

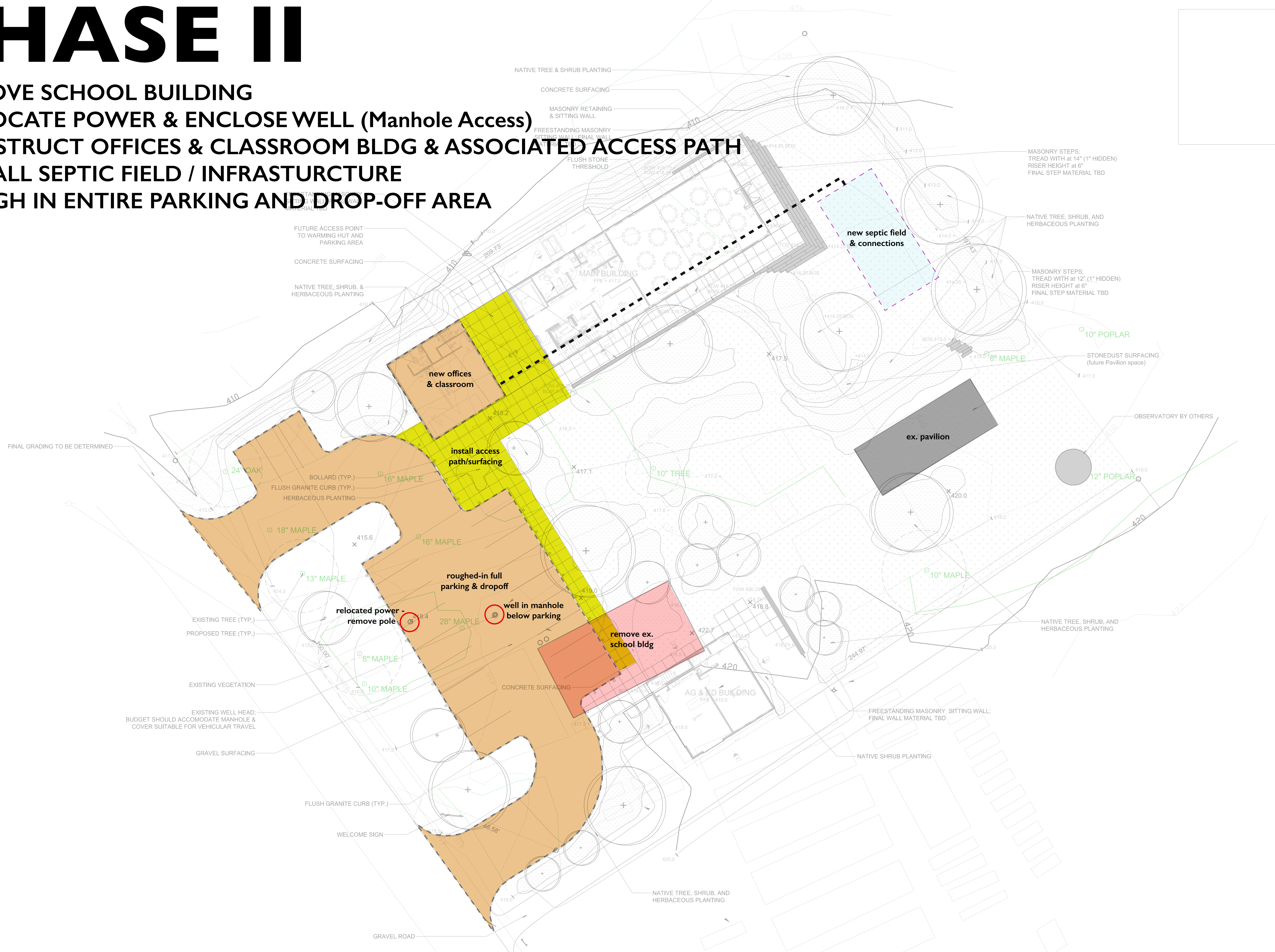

**ESTIMATED LANDSCAPE TOTAL COST PERCENTAGE = 15%**  
 (does not include site engineering costs)

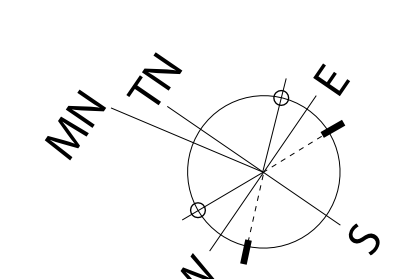

# PHASE III

- CONSTRUCT REMAINING BARN STRUCTURE
- INSTALL EXTERIOR HARDSCAPE ELEMENTS (Surfacing & Walls)
- INSTALL FULL LANDSCAPE PLAN
- INSTALL SEPTIC FIELD / INFRASTRUCTURE TO FUTURE AG BLDG
- CONSTRUCT BRIDGE & PATH FROM SKI CTR.

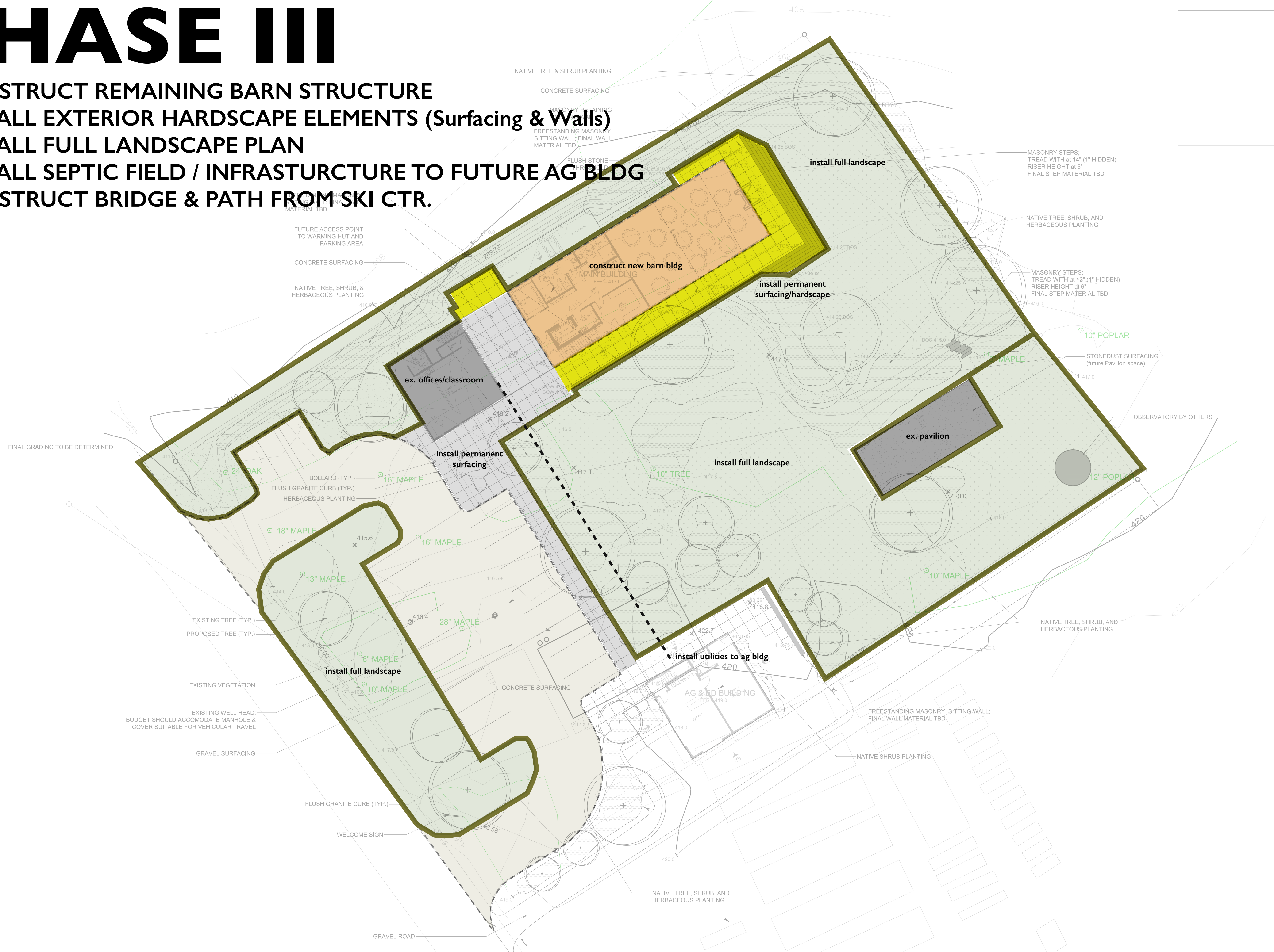

**ESTIMATED LANDSCAPE TOTAL COST PERCENTAGE = 70%**  
 (does not include site engineering costs)

# PHASE IV

## - CONSTRUCT AGRICULTURAL BLDG & ASSOCIATED LANDSCAPE

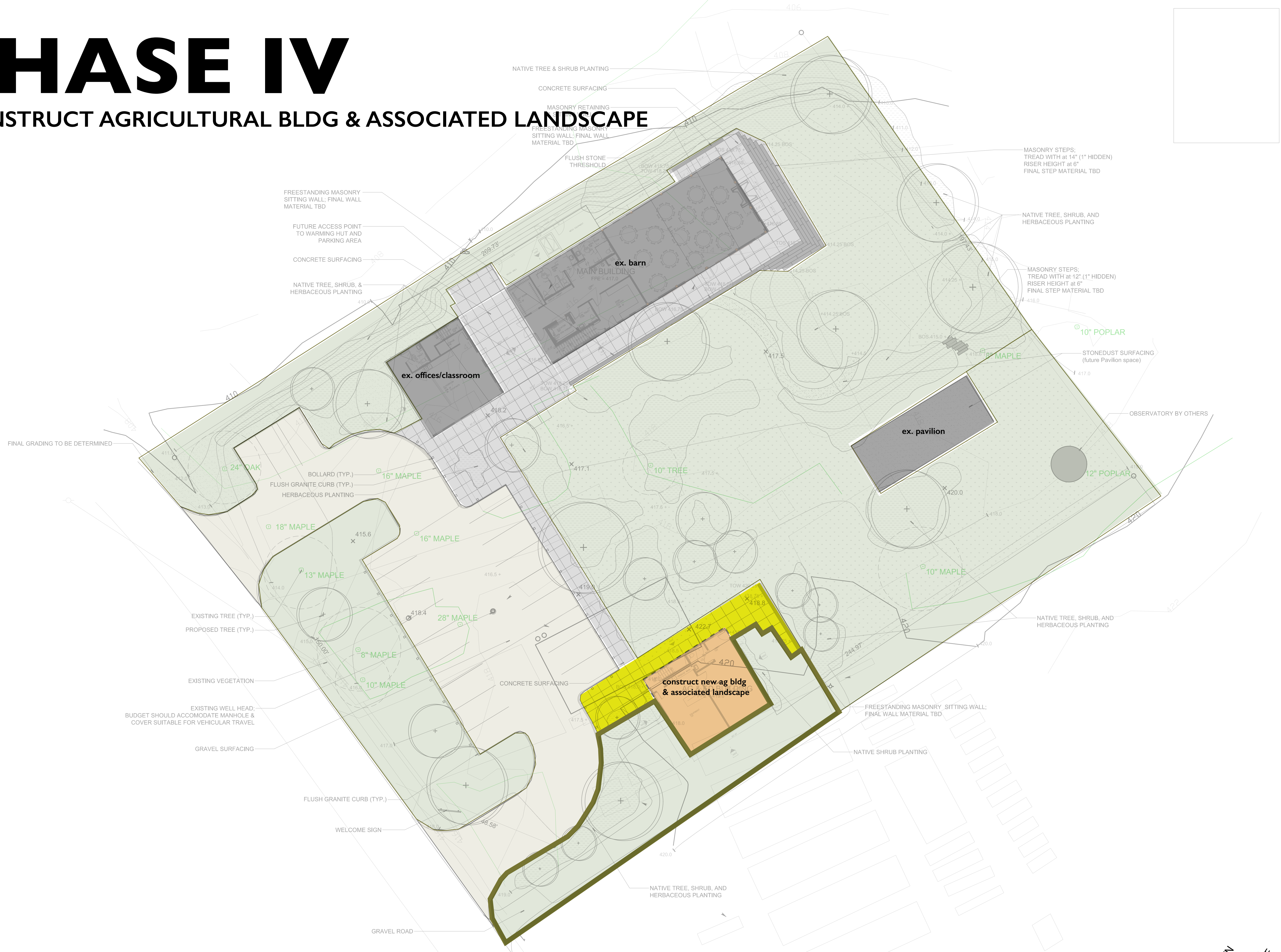

**ESTIMATED LANDSCAPE TOTAL COST PERCENTAGE = 15%**  
(does not include site engineering costs)